

NORTH

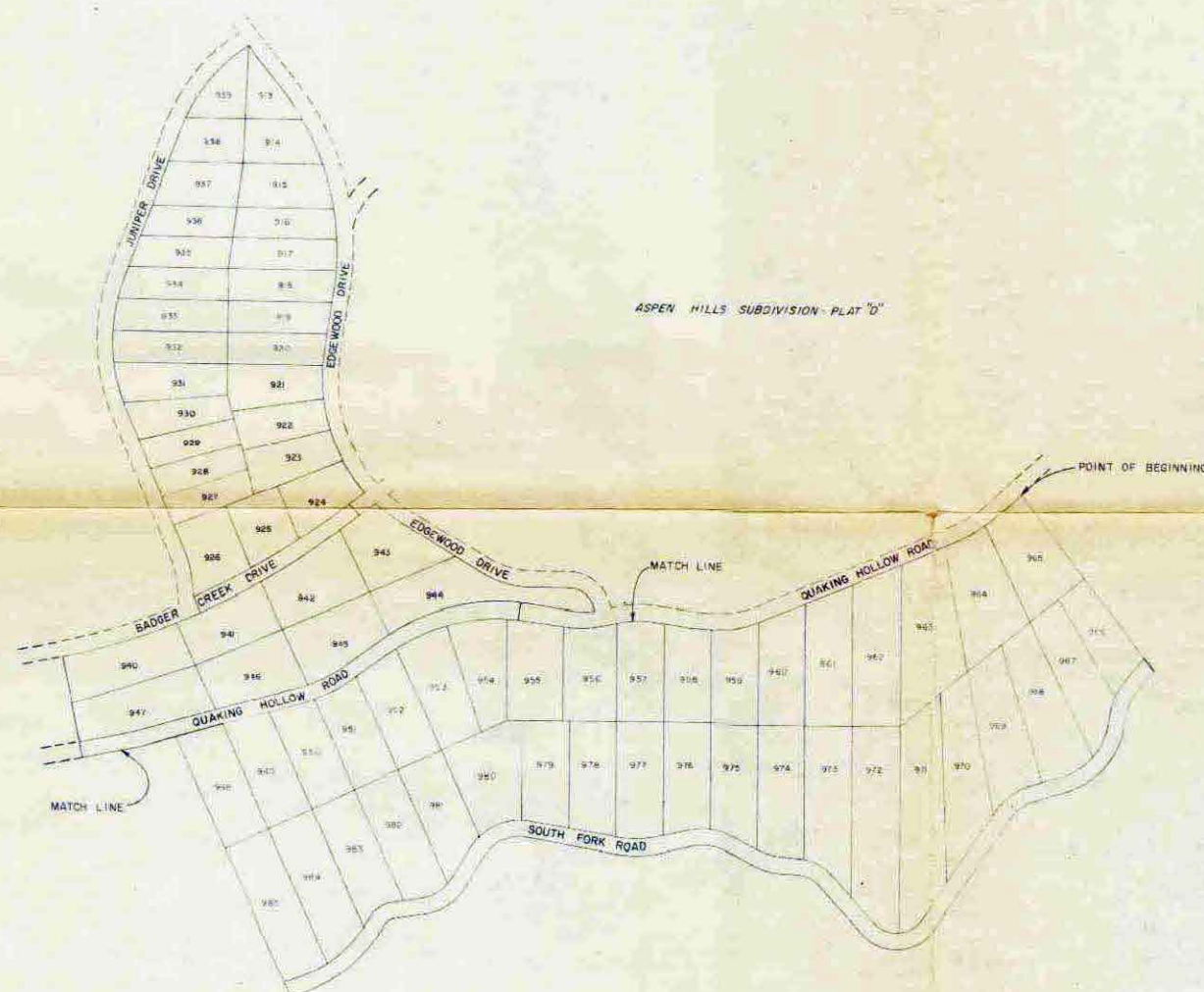
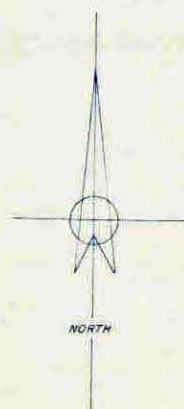

ASPEN HILLS SUBDIVISION - PLAT "A"

BOUNDARY DESCRIPTION (continued from right)

COURSE (RADIIUS)	DISTANCE (ARC LENGTH)	REMARKS
S 80° 54' 36" W	100.51'	THENCE ALONG A CURVE TO THE LEFT
S 80° 54' 36" W	33.64'	THENCE
S 3° 29' 37" W	21.94'	THENCE ALONG A CURVE TO THE RIGHT
S 3° 29' 37" W	367.38'	THENCE
N 24° 47' 09" W	50.00'	THENCE
N 24° 47' 09" W	842.94'	THENCE
S 74° 28' 33" W	150.82'	THENCE ALONG A CURVE TO THE RIGHT
S 74° 28' 33" W	83.10'	THENCE
S 70° 47' 44" W	74.55'	THENCE
N 10° 12' 16" W	50.00'	THENCE
N 8° 56' 10" W	285.41'	THENCE ALONG A CURVE TO THE LEFT
N 8° 56' 10" W	407.23'	THENCE
N 65° 30' 07" E	42.98'	THENCE
N 24° 09' 56" W	50.00'	THENCE
N 8° 11' 00" W	61.66'	THENCE ALONG A CURVE TO THE LEFT
N 8° 11' 00" W	78.28'	THENCE
N 21° 59' 00" W	507.50'	THENCE ALONG A CURVE TO THE RIGHT
N 21° 59' 00" W	427.85'	THENCE
N 20° 39' 00" E	409.81'	THENCE ALONG A CURVE TO THE RIGHT
N 20° 39' 00" E	325.54'	THENCE
N 53° 05' 19" E	26.13'	THENCE
S 37° 43' 00" E	174.68'	THENCE ALONG A CURVE TO THE RIGHT
S 37° 43' 00" E	667.23'	THENCE
S 7° 47' 46" W	203.35'	THENCE ALONG A CURVE TO THE LEFT
S 7° 47' 46" W	479.52'	THENCE
S 51° 01' 30" W	64.07'	THENCE
S 30° 58' 30" E	50.00'	THENCE
N 51° 01' 30" E	67.92'	THENCE ALONG A CURVE TO THE LEFT
N 51° 01' 30" E	123.74'	THENCE
S 58° 28' 00" E	277.57'	THENCE ALONG A CURVE TO THE LEFT
S 58° 28' 00" E	164.93'	THENCE
S 88° 57' 03" E	123.60'	THENCE ALONG A CURVE TO THE RIGHT
S 88° 57' 03" E	98.29'	THENCE
S 22° 41' 38" E	18.58'	THENCE ALONG A CURVE TO THE RIGHT
S 22° 41' 38" E	72.74'	THENCE
N 82° 04' 05" W	143.21'	THENCE
S 7° 45' 55" W	50.00'	THENCE
S 82° 14' 09" E	143.21'	THENCE ALONG A CURVE TO THE LEFT
S 82° 14' 09" E	100.57'	THENCE
N 78° 13' 54" E	68.44'	THENCE ALONG A CURVE TO THE RIGHT
S 29° 00' 00" E	103.46'	THENCE
S 81° 40' 28" E	119.00'	THENCE ALONG A CURVE TO THE LEFT
S 81° 40' 28" E	236.87'	THENCE
N 67° 09' 12" E	667.18'	THENCE ALONG A CURVE TO THE LEFT
N 67° 09' 12" E	154.12'	THENCE
N 47° 25' 54" E	104.23'	TO POINT OF BEGINNING

CONTAINS 88.94 ACRES

NOTICE TO PURCHASERS OF SUMMER SUBDIVISION LOTS

THIS SUBDIVISION HAS BEEN APPROVED IN ACCORDANCE WITH THE SUMMER HOME SUBDIVISION PROVISIONS OF THE SUBDIVISION REGULATIONS OF SANPETE COUNTY WHICH WAIVE THE REQUIREMENTS FOR THE PROVISION OF A DEDICATED PUBLIC STREET AND REDUCE THE REQUIREMENTS FOR AN APPROVED WATER SUPPLY SYSTEM TO STATE BOARD OF HEALTH SUMMER HOME STANDARDS FOR SUCH WATER SUPPLY SYSTEM.

6-10-77 8:30 A.M. Filed
Aspen Hills Corporation
66.50

Key Map, Plat F, Page 1 of 3

SURVEYOR'S CERTIFICATE

I, GILBERT R. HORROCKS, DO HEREBY CERTIFY THAT I AM A REGISTERED LAND SURVEYOR, AND THAT I HOLD CERTIFICATE NO. 3825, AS PRESCRIBED UNDER THE LAWS OF THE STATE OF UTAH. I FURTHER CERTIFY BY AUTHORITY OF THE OWNERS, I HAVE MADE A SURVEY OF THE TRACT OF LAND SHOWN ON THIS PLAT AND DESCRIBED BELOW, AND HAVE SUBDIVIDED SAID TRACT OF LAND INTO LOTS, BLOCKS, STREETS, AND EASEMENTS AND THE SAME HAS BEEN CORRECTLY SURVEYED AND STAKED ON THE GROUND AS SHOWN ON THIS PLAT AND THAT THIS PLAT IS TRUE AND CORRECT.

BOUNDARY DESCRIPTION

COMMENCING AT A POINT THAT IS 4642.02 FEET NORTH AND 11,020.76 FEET EAST OF THE SOUTHWEST CORNER OF SECTION 32, T.14 S., R.9 E., SALT LAKE BASE & MERIDIAN, THENCE AS FOLLOWS:

COURSE	DISTANCE	REMARKS
S 36° 55' 15" E	651.00'	THENCE
S 36° 55' 15" E	50.00'	THENCE
S 36° 16' 30" W	75.95'	THENCE ALONG A CURVE TO THE LEFT
S 36° 16' 30" W	83.50'	THENCE
S 12° 54' 27" W	84.74'	THENCE ALONG A CURVE TO THE RIGHT
S 12° 54' 27" W	275.78'	THENCE
S 73° 01' 28" W	104.33'	THENCE ALONG A CURVE TO THE LEFT
S 73° 01' 28" W	98.24'	THENCE
S 33° 48' 53" W	423.62'	THENCE ALONG A CURVE TO THE RIGHT
S 33° 48' 53" W	468.81'	THENCE
N 42° 07' 58" W	206.79'	THENCE ALONG A CURVE TO THE LEFT
N 42° 07' 58" W	72.48'	THENCE
N 86° 53' 06" W	49.33'	THENCE ALONG A CURVE TO THE RIGHT
N 86° 53' 06" W	106.58'	THENCE
N 62° 33' 54" W	89.59'	THENCE ALONG A CURVE TO THE LEFT
N 62° 33' 54" W	112.65'	THENCE
S 77° 59' 19" W	101.16'	THENCE ALONG A CURVE TO THE RIGHT
S 77° 59' 19" W	150.46'	THENCE
N 80° 17' 36" W	282.29'	THENCE ALONG A CURVE TO THE LEFT
N 80° 17' 36" W	157.04'	THENCE
S 30° 59' 52" W	107.82'	THENCE ALONG A CURVE TO THE RIGHT
S 30° 59' 52" W	162.21'	THENCE

(CONTINUED AT LEFT)

BASIS OF BEARING

SOLAR OBSERVATION - DECEMBER 14, 1972

DATE

DATE

OWNERS' DEDICATION

KNOW ALL MEN BY THESE PRESENTS THAT WE, ALL OF THE UNDERSIGNED OWNERS OF ALL OF THE PROPERTY DESCRIBED IN THE SURVEYOR'S CERTIFICATE HEREON AND SHOWN ON THIS MAP, HAVE CAUSED THE SAME TO BE SUBDIVIDED INTO LOTS, BLOCKS, STREETS AND EASEMENTS AND DO HEREBY DEDICATE THE STREETS AND OTHER PUBLIC AREAS AS INDICATED HEREON FOR PERPETUAL USE OF THE PUBLIC.

IN WITNESS WHEREOF WE HAVE HEREUNTO SET OUR HANDS THIS 21st DAY OF May A.D. 1974. Aspen Hills Corporation
By: [Signature] Pres.
Vaugh Cummings Sec.

ACKNOWLEDGEMENT

STATE OF UTAH

SANPETE COUNTY

ON THE 21st DAY OF May A.D. 1974, PERSONALLY APPEARED BEFORE ME THE SIGNERS OF THE FOREGOING DEDICATION WHO DULY ACKNOWLEDGE TO ME THAT THEY DID EXECUTE THE SAME
MY COMMISSION EXPIRES April 29, 1978
[Signature] NOTARY PUBLIC
(See Seal Below)

ACCEPTANCE BY LEGISLATIVE BODY

THE SANPETE COUNTY, APPROVES THIS SUBDIVISION AND HEREBY ACCEPTS THE DEDICATION OF ALL STREETS, EASEMENTS, AND OTHER PARCELS OF LAND INTENDED FOR PUBLIC PURPOSES FOR THE PERPETUAL USE OF THE PUBLIC THIS DAY OF May A.D. 1974

APPROVED [Signature] ENGINEER
[Signature] CLERK-RECORDER
(See Seal Below)

BOARD OF HEALTH

APPROVED SUBJECT TO THE FOLLOWING CONDITIONS

CITY-COUNTY HEALTH DEPARTMENT

PLANNING COMMISSION APPROVAL

APPROVED THIS 5th DAY OF April A.D. 1977 BY THE
Sanpete County
[Signature] CHAIRMAN, PLANNING COMMISSION
[Signature] DIRECTOR SECRETARY

PLAT "F"

ASPEN HILLS SUBDIVISION

SUBDIVISION

MOUNT PLEASANT SANPETE COUNTY, UTAH

SCALE: 1" = 300 FEET

SURVEYOR'S SEAL NOTARY PUBLIC SEAL CITY-COUNTY ENGINEER SEAL CLERK-RECORDER SEAL

This form approved by Sanpete County and the municipalities therein.